



GRAPHISOFT.
ARCHICAD 21

Innovation has been a key differentiator for ARCHICAD® since the beginning. ARCHICAD 21 introduces the highly-anticipated Stair Tool, featuring GRAPHISOFT®'s patent-pending Predictive Design™ technology.

STAIR TOOL

Designing stairs is one of the most complex tasks in architecture. ARCHICAD 21's new Stair Tool evaluates thousands of design options and offers the most optimal stair designs to choose from in the context of the specific building. By doing the heavy lifting in the background – making sure the stair complies with global and local design standards – this tool turns what is usually a painful task into something fun.

RAILING TOOL

The new Railing Tool can be used to create complex, associative railings for Stairs, Slabs, Walls, Roofs or Meshes. The configurable Railing Pattern Editor offers unique railing patterns specific to each design project. Railings can be created with a single click based on pre-defined rules and standards.

PRO VISUALIZATION

ARCHICAD 21's integrated CineRender – based on MAXON's Cinema 4D v18 rendering engine – offers architects high quality, photo-realistic rendering in the BIM context. The latest version introduces Light Mapping and Secondary GI methods for more realistic, yet fast rendering.



ELEMENT CLASSIFICATION

ARCHICAD 21 introduces a flexible way to classify elements and spaces for better support of national or company standards and for unprecedented interoperability between project stakeholders.

OPEN BIM™



COLLISION DETECTION

With the evolution of BIM as the de facto workflow, architects increasingly receive consultant information in a BIM format. To help architects fulfil their role as lead coordinator of the model, Collision Detection allows two groups of elements to be compared through user-defined criteria sets.

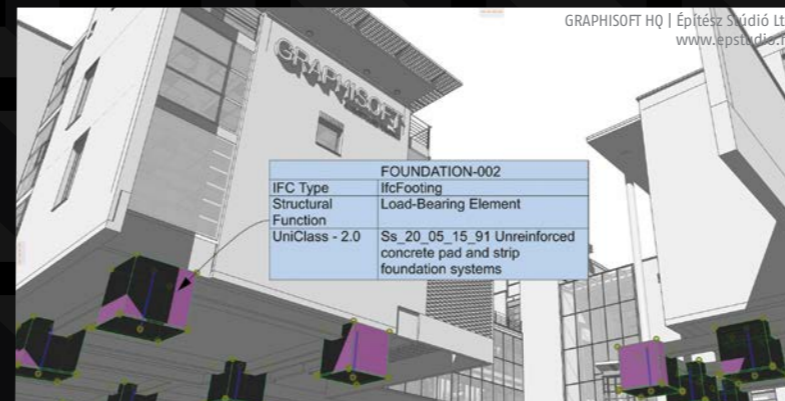

IFC HOTLINKS

External IFC model content created by external consultants – such as Structural or MEP engineers – can be placed as hotlinks into ARCHICAD 21 design projects as protected reference content. These IFC modules can be easily updated ensuring streamlined, round-trip collaboration with engineers.

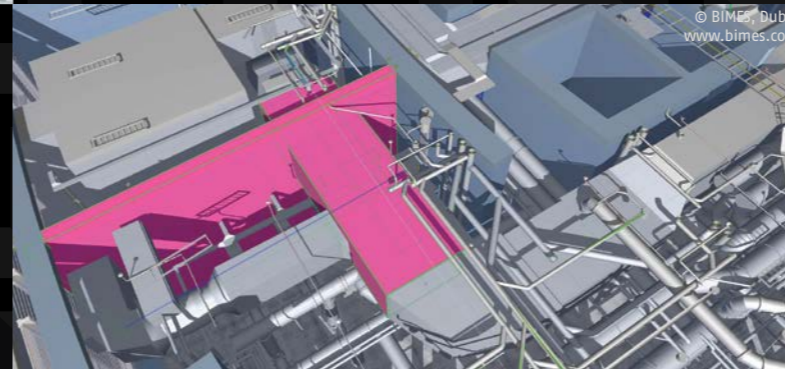

STEP UP YOUR BIM

GRAPHISOFT ARCHICAD 21

For more details, contact any GRAPHISOFT office, or visit: graphisoft.com/archicad

Brasil
GRAPHISOFT Brasil
Phone: +55 11 3045 4350
E-mail: brasil@graphisoft.com
Web: www.graphisoft.com/br

Russia & CIS
GRAPHISOFT Representative Office
Phone: +7 495 510 2503
E-mail: russia@graphisoft.com
Web: www.graphisoft.ru

China
GRAPHISOFT Beijing Rep. Office
Phone: +86 10 6310 2808
E-mail: mail@graphisoft.cn
Web: www.graphisoft.cn

Singapore
GRAPHISOFT Singapore
Phone: +65 6710 7720
E-mail: mail@graphisoft.sg
Web: www.graphisoft.sg

Germany, Austria
GRAPHISOFT Deutschland GmbH
Phone: +49 89 746 430
E-mail: mail@graphisoft.de
Web: www.graphisoft.de

Southeast Asia
GRAPHISOFT Asia Ltd.
Phone: +852 3975 3260
E-mail: mail@graphisoft.hk
Web: www.graphisoft.hk

Italy
GRAPHISOFT Italy
Phone: +39 041 894 3500
E-mail: italia@graphisoft.com
Web: www.graphisoft.com/it

United Kingdom
GRAPHISOFT UK Ltd.
Phone: +44 1895 527 590
E-mail: sales@graphisoft.co.uk
Web: www.graphisoft.co.uk

Japan
GRAPHISOFT Japan Co., Ltd.
Phone: +81 3 55 45 3800
E-mail: info@graphisoft.co.jp
Web: www.graphisoft.co.jp

United States, Canada
GRAPHISOFT North America, Inc.
Phone: +1 617 485 4200
E-mail: info@graphisoft.com
Web: www.graphisoft.com

Mexico & Latin America
GRAPHISOFT Mexico
Phone: +52 5687 1460
E-mail: info@graphisoft.mx
Web: www.graphisoft.mx

Image Credits: Charles Perkins Centre, Australia
fjmt - francis-jones morehen thorp - <https://fjmtstudio.com> | Photo © Keira Yang Zhang
GRAPHISOFT, ARCHICAD, BIMx, BIMcloud are registered trademarks of GRAPHISOFT SE.
Other names may be trademarks of their respective owners.